









Acme Sanitary Ware Co Ltd

Acme Building, 22-28 Nanking Street, Kowloon, Hong Kong
 Tel: 2388 7171 Fax: 2710 8012
 E-mail: acme@acmesanitary.com.hk
 Website: www.acmesanitaryware.com.hk

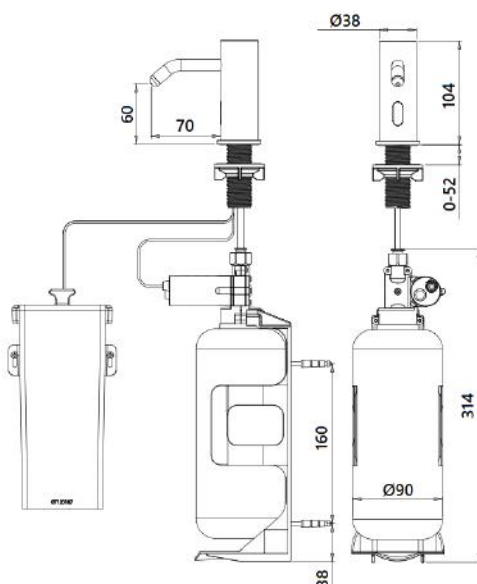

| | | | | | | |
|----------|--|------|--|-----|-----------|--|
| PROJECT | | REF | | REV | ITEM CODE | |
| LOCATION | | DATE | | | PAGE | |

SANITARY WARE SPECIFICATION SHEET

| Item Descriptions | Stern (Israel) "Extreme SD" Chrome plated liquid soap dispenser with built-in sensor in DC Supply with 6D battery box | Illustration/ Drawing | | | | | | | | | | | | |
|---|---|--|----------------------|--|--------------|------------------|---------------------------|---|----------------------------------|--|---|--|--------|--|
| Dimensions | 70 mm Long | | | | | | | | | | | | | |
| Model | Extreme Soap Dispenser B | | | | | | | | | | | | | |
| Code Number | 237920 | | | | | | | | | | | | | |
| Finish | Chrome Plated | | | | | | | | | | | | | |
| Supplier | Acme Sanitary Ware Co. Ltd Mr. Eric Wong/ Mr. Don Yuen (852) 2388-7171 / (852) 2710-8012 acme@acmesanitary.com.hk www.acmesanitary.com.hk | | | | | | | | | | | | | |
| Contact Tel/Fax | |   | | | | | | | | | | | | |
| E-mail | | | | | | | | | | | | | | |
| Website | | | | | | | | | | | | | | |
| EXTREME SOAP DISPENSER B Ref # 237920 Touch free electronic soap dispenser for deck mounted installations. Activated by infrared sensor. Chrome plated body, other finishes available. Includes a 1 liter soap bottle and bottle support. Optional for remote installation: extension cable and longer piping. The following functions can be performed by using Stern remote control: soap quantity selection, refill the soap tank, temporary off, coming back to factory settings. | | | | | | | | | | | | | | |
| Application: Closing automatically without dripping, Stern's touch free soap dispenser helps to ensure that the bathroom will stay organized and neat. Combined with Extreme touch free electronic faucet, it creates a germ-free and automated environment. | | | | | | | | | | | | | | |
| Use: Touch free electronic soap dispenser. The soap dispenser is activated automatically when the users bring their hands within the sensor range and stops when the users remove their hands. | | | | | | | | | | | | | | |
| <table><tr><th colspan="2">PRODUCT AT A GLANCE</th></tr><tr><td>Installation</td><td>Lavatory mounted</td></tr><tr><td>Power Supply</td><td><ul style="list-style-type: none">Battery Box for 6D batteries.12V Transformer</td></tr><tr><td>Soap</td><td>1 Liter soap bottle. This soap dispenser includes a peristaltic pump that allows the use of any kind of liquid soap, detergent or antibacterial gel.</td></tr><tr><td>Soap dosage</td><td>Factory setting of 1.2 to 1.6 cc depending on the selected soap. The soap quantity can be changed using the soap dispenser remote control.</td></tr><tr><td>Refill</td><td>Easy to use manual refill button used for soap priming. This function can also be performed with the remote control.</td></tr></table> | | | PRODUCT AT A GLANCE | | Installation | Lavatory mounted | Power Supply | <ul style="list-style-type: none">Battery Box for 6D batteries.12V Transformer | Soap | 1 Liter soap bottle. This soap dispenser includes a peristaltic pump that allows the use of any kind of liquid soap, detergent or antibacterial gel. | Soap dosage | Factory setting of 1.2 to 1.6 cc depending on the selected soap. The soap quantity can be changed using the soap dispenser remote control. | Refill | Easy to use manual refill button used for soap priming. This function can also be performed with the remote control. |
| PRODUCT AT A GLANCE | | | | | | | | | | | | | | |
| Installation | Lavatory mounted | | | | | | | | | | | | | |
| Power Supply | <ul style="list-style-type: none">Battery Box for 6D batteries.12V Transformer | | | | | | | | | | | | | |
| Soap | 1 Liter soap bottle. This soap dispenser includes a peristaltic pump that allows the use of any kind of liquid soap, detergent or antibacterial gel. | | | | | | | | | | | | | |
| Soap dosage | Factory setting of 1.2 to 1.6 cc depending on the selected soap. The soap quantity can be changed using the soap dispenser remote control. | | | | | | | | | | | | | |
| Refill | Easy to use manual refill button used for soap priming. This function can also be performed with the remote control. | | | | | | | | | | | | | |
| <table><tr><th colspan="2">OPTIONAL ACCESSORIES</th></tr><tr><th>PRODUCT NAME</th><th>PART NUMBER</th></tr><tr><td>Heavy Duty Brass Base Kit</td><td>07246036</td></tr><tr><td>Soap dispenser anti-rotation Kit</td><td>07246046</td></tr><tr><td>Remote Control for liquid soap dispensers</td><td>07100008</td></tr></table> | | | OPTIONAL ACCESSORIES | | PRODUCT NAME | PART NUMBER | Heavy Duty Brass Base Kit | 07246036 | Soap dispenser anti-rotation Kit | 07246046 | Remote Control for liquid soap dispensers | 07100008 | | |
| OPTIONAL ACCESSORIES | | | | | | | | | | | | | | |
| PRODUCT NAME | PART NUMBER | | | | | | | | | | | | | |
| Heavy Duty Brass Base Kit | 07246036 | | | | | | | | | | | | | |
| Soap dispenser anti-rotation Kit | 07246046 | | | | | | | | | | | | | |
| Remote Control for liquid soap dispensers | 07100008 | | | | | | | | | | | | | |
|  Installation: Lavatory mounted | |  Power source: Battery box for 6xD batteries | | | | | | | | | | | | |
|  Stern Soap & Water: Extreme matching faucet | | | | | | | | | | | | | | |
|  Default soap dosage: 1.4 cc | | | | | | | | | | | | | | |
|  Soap viscosity: 100-3800 cPs | | | | | | | | | | | | | | |

* All information of the above is for the reference only. No prior notice is made if any changes.



| | | | | | | |
|----------|--|------|--|-----|-----------|--|
| PROJECT | | REF | | REV | ITEM CODE | |
| LOCATION | | DATE | | | PAGE | |

SPARE PARTS LIST

Extreme Soap Dispenser B
(237920)

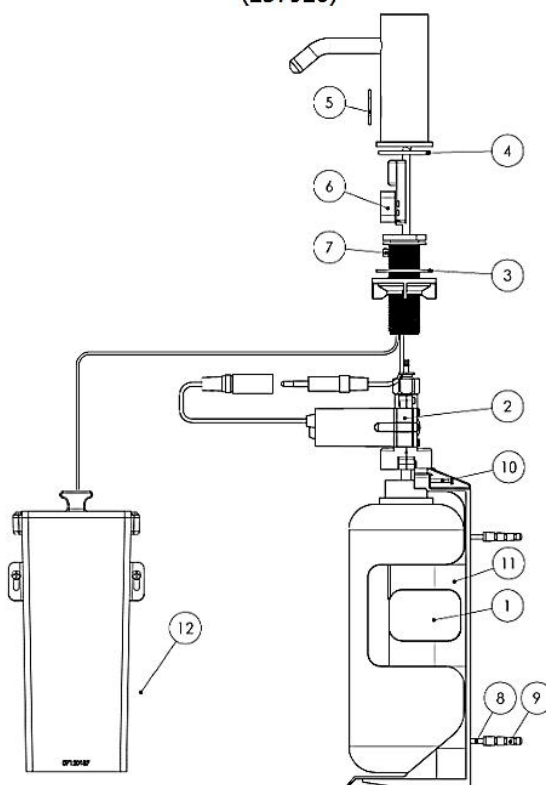

| Quantity | Part Number | Description | Cat. No. |
|----------|-------------|-----------------------------|-----------------|
| | - | Seals and Screws Kit | 07210088 |
| 1 | 4 | O-ring | |
| 1 | 6 | O-ring | |
| 1 | 7 | Screw | |
| 1 | 3 | Gasket | |
| 2 | 8 | Screw | |
| 2 | 9 | Anchor | |
| 2 | 10 | Screw | |
| | - | Sensor Kit | 07220072 |
| 1 | 5 | Electronic Unit | |
| 1 | 6 | O-ring | |
| | 1 | Soap Tank 1L | 07100020 |
| | 2 | Pump Soap Dispenser | 07222001 |
| | 11 | Bottle 1L support | 07120175 |
| | 12 | Battery box | 06530041 |

Note: In order to locate the relevant spare part, please check the corresponding parts and part number in the drawing. Minimum order quantity will be required.

* All information of the above is for the reference only. No prior notice is made if any changes.



INSTALLATION

STEP 1 – REMOVE ALL MOUNTING HARDWARE

For TRENDY, ELITE, EXTREME, SMART, GREEN, GREEN 28 Soap Dispensers:

Drill a hole in the deck or lavatory according to the recommended hole size.

Remove the nut, the disk and the gasket from the base of the soap dispenser body.

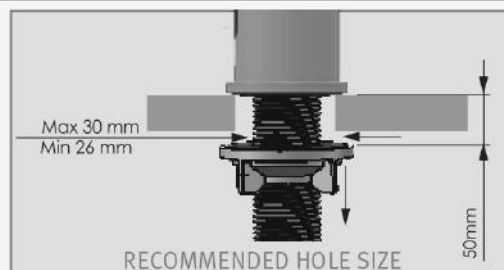

If your dispenser is supplied with anti-rotation solution, drill an additional hole for anti-rotation pin.

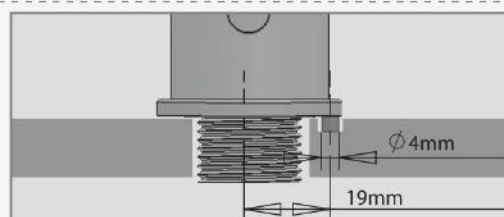
**For CSABA Soap Dispenser:**

Remove the hexagonal nut, disk and washer. Do not remove the O-ring from the base of the faucet.

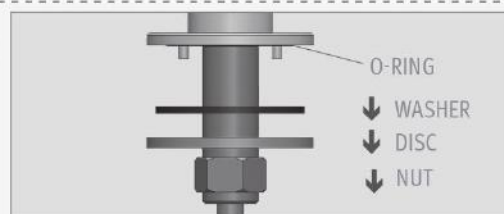

Drill a hole in the counter for the mixing handle. Remove the nut, disk and seal.



STEP 2 – INSTALLING THE SOAP DISPENSER

1

For TRENDY, ELITE, EXTREME, SMART, GREEN, GREEN 28 Soap Dispensers: Place the soap dispenser body along with the bottom ring into the hole in the deck or lavatory.

Slide the gasket, disk and nut over the soap dispenser body nipple and secure it.

**For CSABA Soap Dispenser:**

Slide the washer, disk and hexagonal nut over the flexible hose and secure the faucet into place.

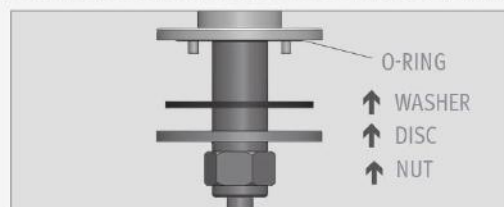



INSTALLATION

2

Fix the bottle with bottle support to the desired location.

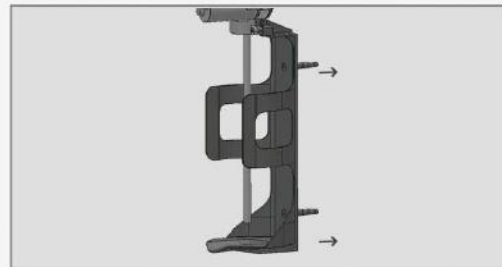

3

Snap the soap pipe from the dispenser body into the quick connection fitting of the pump.



STEP 3 – CONNECTING THE POWER SOURCE

1

Remove the protective sticker covering the sensor. Keep away from the sensor range.

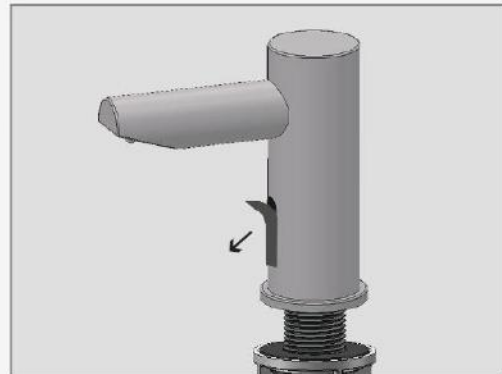

2

Connect the motor connector to its matching connector coming from the electronic unit. Please note that since the connector is water proof, some friction might apply.



O-RING VISIBLE –
NOT CONNECTED PROPERLY



ONLY THE GROOVES ARE VISIBLE –
CONNECTED PROPERLY



INSTALLATION

IMPORTANT: the 4 contacts connector should be connected properly so that the white o-ring is not visible and a clicking sound is heard.

PAY ATTENTION: If the 4 contacts connectors is not connected properly, the motor will work continuously.

2a

For battery versions: install the battery box on the wall underneath the sink and connect the battery connector.

Caution: make sure to connect the connectors according to the indication on the battery box sticker.



2b

For transformer versions: plug the transformer into the electricity socket and connect the transformer connector

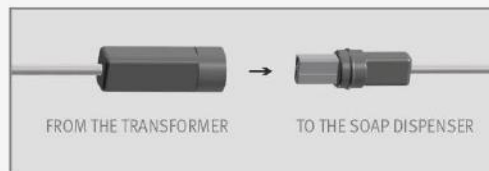

3

Wait about 10 seconds before you put your hands within the sensor range.





TROUBLESHOOTING

| Indication | Investigation | Cause | Solution | Illustration |
|--------------------------------------|--|---|---|--------------|
| False activation: Soap dispensing | Continuous discharge from the nozzle | AUX connector not fully inserted | The connector should be inserted fully until white o-ring is not visible. Remove the o-ring if necessary | |
| | Random discharge from the nozzle | Reflection issue from other object | Eliminate any cause of reflection and if necessary use appropriate remote control to shorten detection range. | |
| | Soap discharging from pump housing. | Damaged pump due to high viscosity or debris in pipes | Replace the Pump. Rinse warm water through the pipe and the body of the soap dispenser all the way to the nozzle. | |
| Soap not dispensing | Pump is making sounds when sensor is activated | Soap tank is empty | Fill with soap with correct viscosity (100 - 3800 cPs) and prime pipes using the fill button on remote control. | |
| | | Soap dispenser has not been primed | Prime the soap dispenser by pressing the fill button on the remote or by pressing the refill button located at the bottom of the pump, until soap exits the nozzle. | |
| | | Damaged pump (discharge from housing) | Replace the Pump | |
| | | Debris or dried soap in the pipe or tank | Run warm water through pipe, pump, and body all the way to the nozzle. Replace with soap of correct viscosity. | |
| | | High viscosity soap (> 3800 cPs) | NOTE: Using the soap dispenser with high viscosity soap may cause permanent damage to the pump and shorten the lifecycle. | |
| | | Bent pipes | Unbend or straighten pipes. | |



TROUBLESHOOTING

| Indication | Investigation | | Cause | Solution | Illustration |
|---------------------|---|---|--|--|---|
| Soap not dispensing | Pump is not making sound when the sensor is activated | Sensor is blinking when hand is placed in front | AUX connector not fully inserted | The connector should be inserted fully until the white o-ring is not visible. Remove the o-ring if necessary | <p>O-RING VISIBLE – NOT CONNECTED PROPERLY</p> <p>ONLY THE GROOVES ARE VISIBLE – CONNECTED PROPERLY</p> |
| | | | Refill button on pump does not activate the pump. | Replace the Pump. Rinse warm water through the pipe and the body of the soap dispenser all the way to the nozzle. | <p>Press</p> |
| | | | Damaged pump (discharge from housing). | | |
| | | | Debris or dried soap in the tank or tubing | Run warm water through pipe, pump, and body all the way to the nozzle. Replace with soap of correct viscosity. NOTE: Using the soap dispenser with high viscosity soap may cause permanent damage to the pump and shorten the lifecycle. | |
| | Sensor is not blinking when hand is placed in front | Refill button on pump does not activate the pump. | Transformer: Check operation with functioning transformer. Where necessary replace with appropriate transformer. For part numbers see spare parts list. | | <p>Refill button</p> |
| | | | Battery: Check operation with functioning battery pack. Where necessary, replace batteries or replace the battery pack: Battery pack (without batteries) | | |
| | | Reflection issue from other object | Eliminate any cause of reflection and use appropriate remote control to shorten detection range. | | <p>Min 1.5 M</p> |
| | | Damaged sensor | If the above two solutions have not resolved this issue replace with appropriate sensor. For part numbers see spare parts list. | | <p>Replace sensor</p> |